



12 RED HALL GARDENS, SHADWELL

LEEDS, LS17 8NG

£580,000
FREEHOLD

Welcome to 12 Red Hall Gardens a wonderful five-bedroom family home situated on a peaceful cul-de-sac in Shadwell. Boasting 2220qft of living space, and with easy access to outstanding schools and countryside walks, this property offers a wealth of amenities just a short distance away.

MONROE

SELLERS OF THE FINEST HOMES

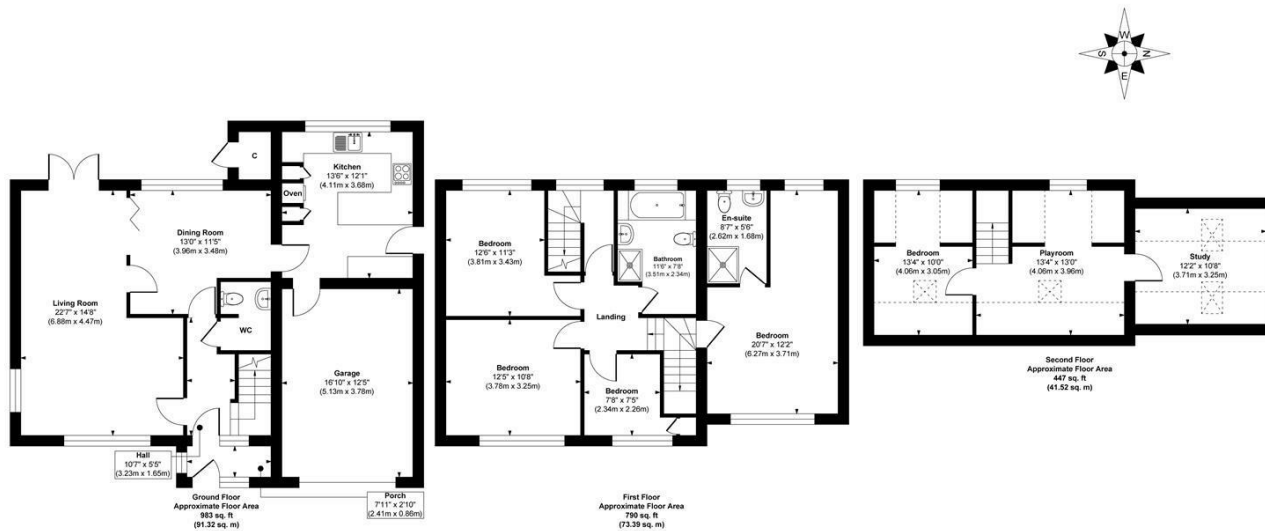

Approx. Gross Internal Floor Area 2220 sq. ft / 206.23 sq. m
 Illustration for identification purposes only, measurements are approximate, not to scale.
 Copyright © Zenith Creations.

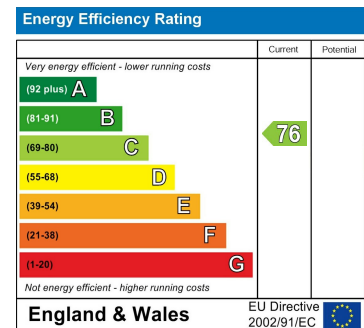

Agents Note: Whilst every care has been taken to prepare these particulars, they are for guidance purposes only. All measurements are approximate and are for general guidance purposes only and whilst every care has been taken to ensure their accuracy, they should not be relied upon and potential buyers/tenants are advised to recheck the measurements

Alwoodley Sales
 716 King Lane Alwoodley
 Leeds
 West Yorkshire
 LS17 7BA

0113 870 4443
 hello@monroeestateagents.com
 www.monroeestateagents.com

MONROE

SELLERS OF THE FINEST HOMES